

LAT PULLDOWN

19-5233

REVISED:
March 30, 2006

PARTS AND SERVICE ► 709 Powerhouse Road ► Independence, VA 24348

SERIAL # _____
through _____

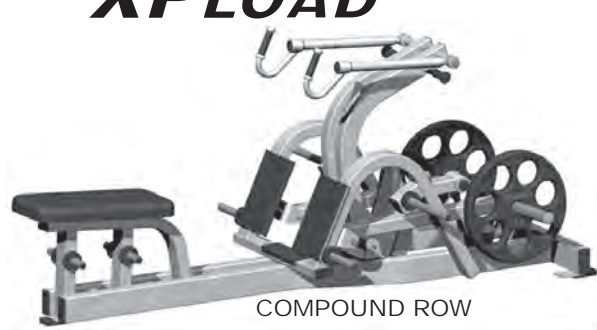

COMPOUND ROW



SEATED CALF



OVERHEAD PRESS



LAT PULLDOWN



INCLINE PRESS



VERTICAL CHEST



LEG PRESS



BICEP CURL



LEG CURL PRONE



INCLINE LEG PRESS



TRICEP EXTENSION



SEATED DIP



DEAD LIFT / SHRUG



LEG EXTENSION



P3LATP LATERAL PULLDOWN

COMP# COMPONENT DESCRIPTION

- 1BSF326.....BASEFRAME P3LATP
- 2HB603.....HANDLE
- 3LK329.....LINK MA/HB P3LATP
- 4MA329.....MOVEMENT ARM RIGHT P3LATP
- 5MA330.....MOVEMENT ARM LEFT P3LATP
- 6HB326.....THIGH PAD ADJUSTER
- 7SF325.....SEAT FRAME P3LATP
- 8WA329.....WEIGHT ARM RIGHT P3LATP
- 9WA330.....WEIGHT ARM LEFT P3LATP
- 10UP8080.....SEAT BOTTOM (SEAM NARROW END)
- 11UP9955.....ROLLER PAD 8" LONG
- 1201-0011.....BOLT HH5 1/2 X 3
- 1301-1565.....BOLT HH5 1/2 X 5
- 1401-2286.....BOLT HH5 5/8 X 6 3/8 CUT-OFF FROM 01-2287
- 1501-2283.....BOLT HH5 5/8 X 8 5/8 PLATED
- 1601-1105.....BOLT HH5 3/8 X 1 1/2
- 1701-1115.....BOLT HH5 3/8 X 2 1/2
- 1801-1553.....BOLT HH5 3/8 X 4 1/2
- 1901-1220.....BOLT HH5 3/8 X 5
- 2001-1560.....BOLT HH5 1/2 X 1 3/4
- 2101-1561.....BOLT HH5 1/2 X 2
- 2201-1564.....BOLT HH5 3/8 X 3/4
- 2301-2182.....BOLT HH5 5/8-18 X 2
- 2401-2190.....BOLT HH5 5/8-11 X 3"
- 2501-2220.....BOLT HH5 5/8-11 X 4 1/2
- 2601-2240.....BOLT HH5 5/8 X 5 1/2
- 2702-3055.....1/4-28 X 1/4 SET SCREW
- 2802-4065.....BOLT 1/4-20 X 2 3/4 SLOTTED SCREW
- 2903-1035.....3/8 NUT
- 3003-1055.....NUT FLANGE 1/2-13
- 3103-1067.....5/8-11 LOCK NUT
- 3206-8166.....1.875 SNAP RING
- 3303-5101.....NUT BLACK 1/4-20 HEX
- 3403-5119.....5/8-18 RIGHT HAND THREAD JAM NUT
- 3504-5207.....1/2 FLAT WASHER
- 3604-5213.....3/8 INT LOK WASHER
- 3704-5214.....1/2 LOK WASHER
- 3804-5215.....5/8 LOK WASHER
- 3904-5225.....WASHER INT LOCK BLACK 1/4
- 4005-5105.....1/2 ID IGUS BUSHING
- 4106-8180.....1/2 THIN SNAP RING
- 4206-8263.....SNAP RING INTERNAL 1 9/16" DIA 5000-156
- 4306-8275.....RING SNAP EXT. 17mm
- 4406-8285.....SNAP RING INTERNAL 1 3/4
- 4506-9035.....ROD ENDS 5/8-18 RH THREADS CTMD-10
- 4607-4124.....PULL PIN ASSY. (STRAIGHT LONG PIN)
- 4707-5032.....SEAT TRACK FRONT
- 4807-5033.....SEAT TRACK REAR
- 4907-5034.....MOLDED WHEELS
- 5007-5064.....6203 BEARINGS (NOT FAFNIR)
- 5107-5065.....203PP BEARING
- 5207-8230.....STANDARD SEAT PIN
- 5307-9376.....SEAT BEARING SLEEVE
- 5407-9421.....3" SPACER
- 5507-9425.....3/4 SEAT ADJUSTMENT SPACER
- 5607-9605.....BEARING SLEEVE 1 OD X 5 15/16 L
- 5707-9607.....BEARING CUPS WITH BEARINGS
- 5807-9610.....LINKAGE BUSHING
- 5907-9625.....WEIGHT TUBE 1 7/8 X .25W TUBE X 16" LONG
- 6007-9652.....1/2 X 2 X 44" L CONTROL LINK
- 6107-9680.....SEAT SHEETMETAL
- 6209-4092.....RUBBER BUMPER STOP
- 6308-2058.....SPACERS FOR UPH. ROLLER PADS
- 6408-5067.....SLEEVE
- 6509-1004.....1/2 X 3 CLOSED END GRIP (YELLOW)
- 6609-1023.....HAND GRIP 7/8" ID X 3 3/4" OPEN END
- 6709-2070.....2X2 FRAME PLUG
- 6809-2090.....2 X 3 FRAME PLUG
- 6909-3042.....1 3/4 OD X 1 3/8 ID FRAME PLUG
- 7009-3055.....2 X 4 FRAME PLUG
- 7109-3064.....7/16" WHITE HOLE PLUG
- 7209-3066.....1 1/4" WHITE HOLE PLUG
- 7309-3090.....HOLE PLUG (BLACK)
- 73A.....09-3091.....HOLE PLUG (YELLOW)
- 7409-4064.....WEIGHT STORAGE BUMPER, 1.875 ID X 3/4 X 3" OD RUBBER
- 7509-4077.....SQUARE BUSHINGS 3/4" ID
- 7609-5010.....DOCK BUMPER
- 7709-5045.....NEW RECTANGULAR FOOTPAD
- 7809-9505.....GRIP CAP ALUMINUM (FOR 1" DIA BAR)
- 7909-9535.....GRIP RING ALUMINUM (FOR 1" DIA BAR)

COMP# COMPONENT DESCRIPTION

- 8009-8172.....1 3/4 DIA HOLE PLUG BLACK
 - 8112-5331.....INSTRUCTIONAL PLACARD P3LATP
 - 8210-1022.....EXTENSION SPRING
 - 8310-1025.....TORSION SPRING
 - 8412-1001.....SEAT INDICATOR ARROW BLACK
 - 8512-1185.....NAUTILUS DECAL GREY
 - 8612-1026.....KEEP HANDS AWAY (YELLOW)
 - 8712-1380.....INSPECTION STICKER DECAL
 - 8812-1104.....5/8" WIDE DECAL, 1/2" INCREMENTS (1 TOP-11 BOTTOM)
 - 8912-1129.....SEAT ADJ. DECAL (L-M-S)
 - 89A.....12-1166.....DECAL SEAT ADJ. INSTRUCTIONS
 - 9012-1194.....DECAL THIGH PAD ADJ. 1-6
 - 9119-1013.....2 3/4 WIDE DBL. SIDED TAPE
 - 9219-1012.....TAPE DOUBLE SIDED 1 1/2 X 1 1/2, 2 PCS.
 - 9319-1291.....DECAL SERIAL # BAR CODE
 - 9419-1342.....MOVEMENT ARM STOP
 - 9519-5233.....PARTS DIAGRAM (P3LATP RATCHET SEAT)
 - 9640-7167.....BAG 50 X 46 X 86 X .002 THICK
 - 9791-999.....PAINT POWDER
 - 9802-9220.....BOLT HH5 3/8 X 1 1/4
 - 9901-1564.....BOLT HH5 1/2 X 4 1/2
 - 99A.....09-9600.....TUBE INSERT
 - 99B.....02-2290.....1/4 X 1 AFH SCREW
- P3LATP WEIGHT STORAGE KIT OPT-WT-BAR04
- 100.....01-1105.....BOLT HH5 3/8 X 1 1/2
 - 101.....04-5213.....3/8 INT LOK WASHER
 - 102.....07-7010.....PIN ROLL 1/4 X 1
 - 103.....07-9690.....WEIGHT STORAGE BENT
 - 104.....07-9792.....WEIGHT STORAGE 16 1/2" L
 - 105.....07-9644.....WEIGHT STORAGE 14 3/4" L
 - 106.....09-4066.....WEIGHT STORAGE BUMPER, 3/4 X 3" OD RUBBER
 - 107.....09-4000.....NUMBER PLUG 5 lb.
 - 108.....09-4001.....NUMBER PLUG 10 lb.
 - 109.....09-4002.....NUMBER PLUG 25 lb.
 - 110.....09-4003.....NUMBER PLUG 45 lb.
 - 111.....01-1185.....BOLT HH5 3/8 X 3 1/2

RED: PAINTED ITEMS
 _____ Trolleys / Machine

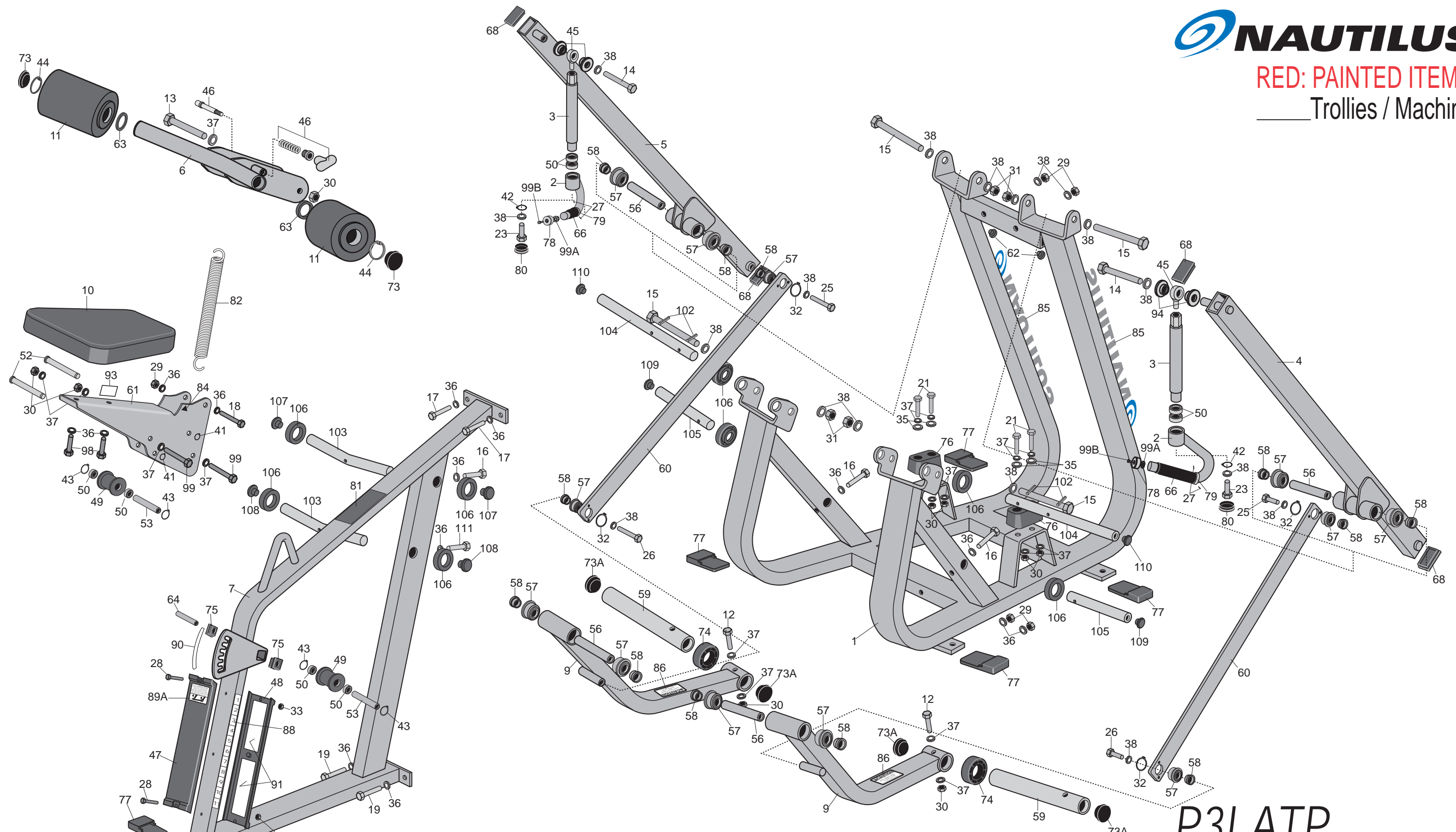

72 09-3064 7/16" HOLE PLUG
 09-3066 1-1/4" HOLE PLUG
 (USED WITHOUT WEIGHT STORAGE PIN KIT.)
 71

Last Rev Date: 03/30/06

**P3LATP
 LAT PULLDOWN
 Nautilus Parts Diagram**